

TERMINALS OF ECU

1. CHECK COMBINATION METER ASSEMBLY

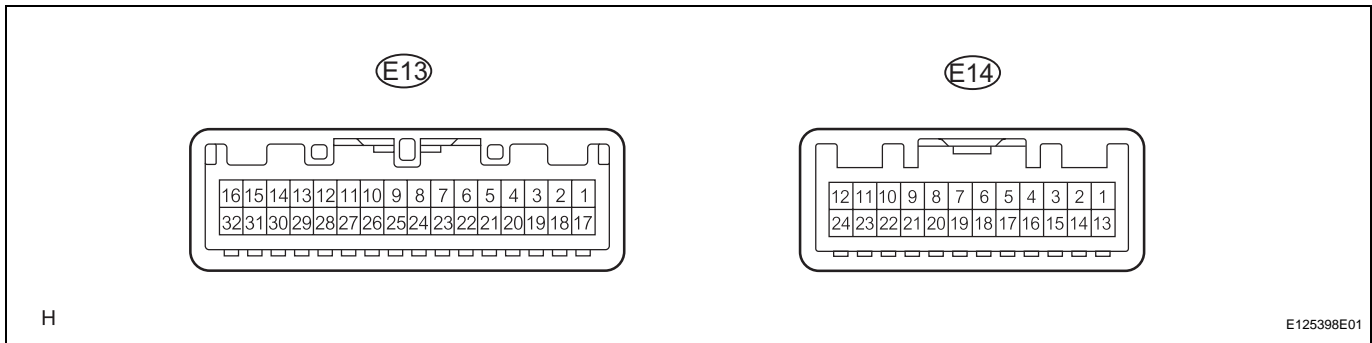

- (a) Using the tester probes, touch the terminals from the back of the vehicle wire harness connectors, and measure the voltages and resistances.

Standard:

Symbols (Terminal No.)	Wiring Color	Terminal Description	Condition	Specified Condition
IG+ (E13-2) - Body ground	R-L - Body ground	Ignition switch signal	Ignition switch OFF → ON	Below 1 V → 11 to 14 V
B (E13-1) - Body ground	R - Body ground	Battery	Always	11 to 14 V
KSW (E13-9) - Body ground	V-G - Body ground	Key unlock warning switch signal input	Key inserted → Key removed from ignition key cylinder	Below 1 V → 10 to 14 V
DOOR (E13-29) - Body ground	W-L - Body ground	Driver door courtesy switch signal input	Driver door closed → open	Below 1 V → 11 to 14 V
ES (E13-21) - Body ground	W-B - Body ground	Ground	Always	Below 1 Ω

If the result is not as specified, there may be a malfunction in the wire harness.

2. CHECK MAIN BODY ECU

Main Body ECU:

Left View:

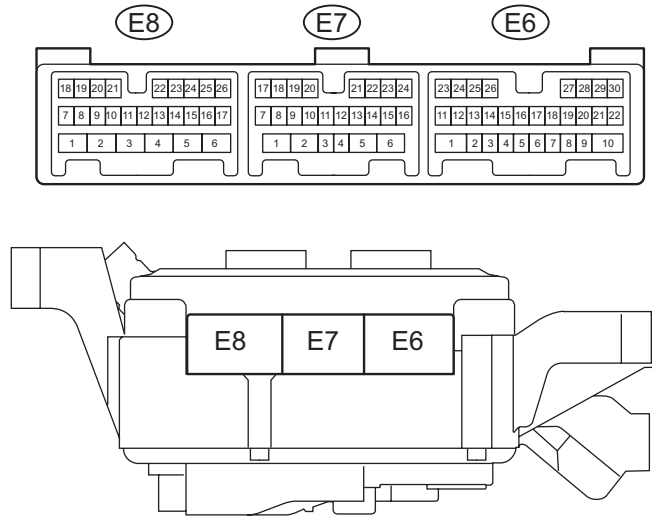

Rear View:

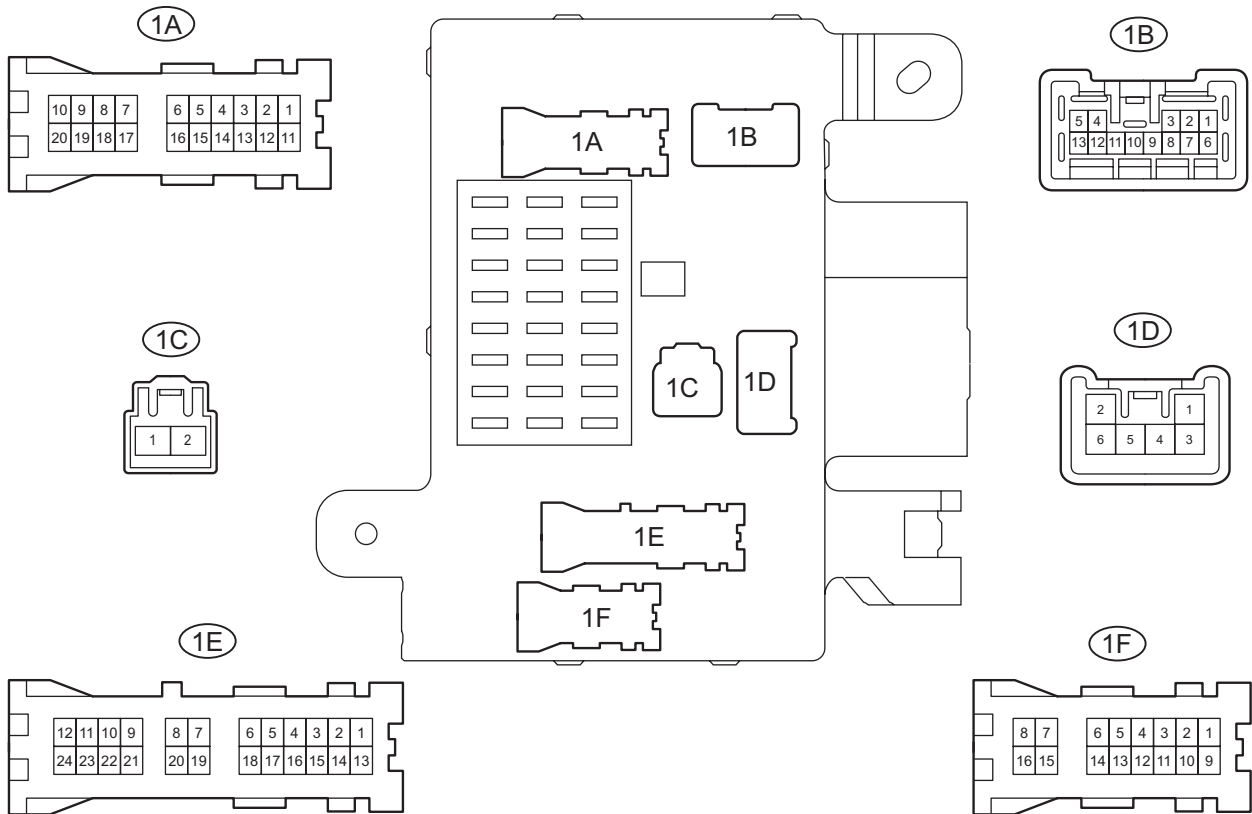

DL

Main Body ECU:

Front View:

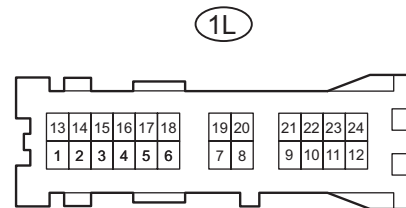
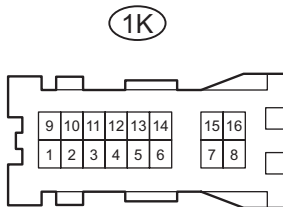
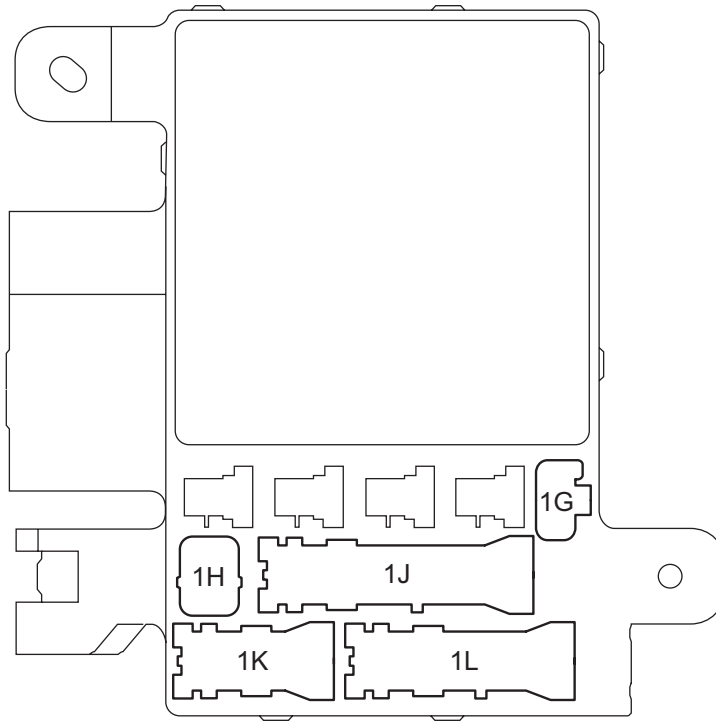
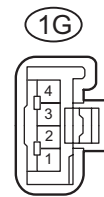
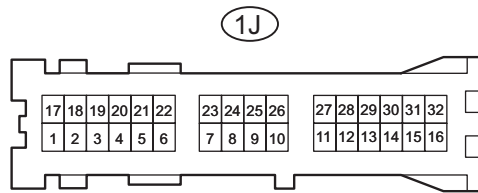
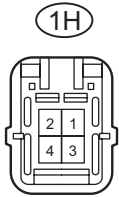

DL

- (a) Using the tester probes, touch the terminals from the back of the vehicle wire harness connectors, and measure the voltages.

Standard voltage:

Symbols (Terminal No.)	Wiring Color	Terminal Description	Condition	Specified Condition
KSW (E8-14) - Body ground	G-Y - Body ground	Key unlock warning switch input	Key inserted → Key removed from ignition key cylinder	Below 1 V → to 14 V
GND1,2 (1H-2) - Body ground	W-B - Body ground	Ground	Always	Below 1 V
BECU (1B-4) - Body ground	W-R - Body ground	Battery	Always	to 14 V
DCTY (E7-23) - Body ground	R-B - Body ground	Driver door courtesy switch input	Driver door closed → open	to 14 V → Below 1 V
KSWO (E8-15) - Body ground	V-G - Body ground	Key unlock warning switch signal output	Key inserted → Key removed from ignition key cylinder	Below 1 V → to 14 V
DCY2 (E8-11) - Body ground	W-L - Body ground	Driver door courtesy switch signal output	Driver door closed → open	10 to 14 V → Below 1 V

If the result is not as specified, there may be a malfunction in the wire harness.